



Old Market Street, Thetford, IP24 2EQ

Rent - Offers In Excess Of £325,000

Deposit -

An extremely rare opportunity to own an exceptional 600 year old Grade II listed residence that blends historical significance with practical living - perfect for those seeking character, heritage, and a place to make their own mark in history.

- APPROXIMATELY 600 YEARS OLD
- RICH IN HISTORICAL SIGNIFICANCE
- OVER 2000 SQ. FT OF ACCOMMDATION ON OFFER
- USEFUL CELLAR
- OFFERED WITH NO ONWARD CHAIN
- GRADE 11 LISTED FOUR BEDROOM PROPERTY
- OOZES CHARM AND HERITAGE
- RARE OPPORTUNITY TO OWN A DISTINCTIVE HOME
- GARAGE AND OFF ROAD PARKING
- VIEWINGS ARE STRONGLY ADVISED!



Council Tax Band: D - EPC Rating: null



Floor -1



Ground Floor

Approximate total area⁽¹⁾
 2304 ft²
 213.9 m²
 Reduced headroom
 26 ft²
 2.4 m²

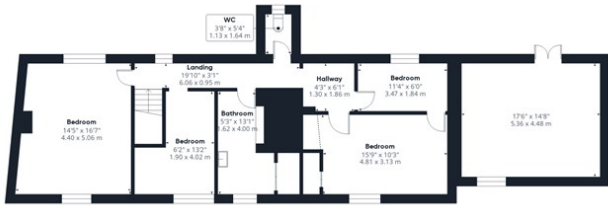

Floor 1

(1) Excluding balconies and terraces

Reduced headroom
 Below 5 ft/1.5 m

Calculations reference the RICS IPMS 3C standard. Measurements are approximate and not to scale. This floor plan is intended for illustration only.

GIRAFFE 360

